

Model 6531-KB3TP

PS/2 Compatible Keyboard



FEATURES

- **Drawer Mount 19" Rack Mount**
- **Keyboard Useable without Lifting out of the Drawer**
- **Keyboard has 104 Keys and Integrated Touchpad**

DESCRIPTION

The 6531-KB3TP Series is a low profile, PS/2 compatible keyboard for use in industrial rack mounted configurations. Included with the keyboard is a Synaptics Touchpad that is fully Microsoft mouse compatible in operation. Additional functionality is provided when using the driver software included with the keyboard. Durability is obtained by the Gold Crosspoint contacts incorpo-

rated which offer a minimum of 50 million operations per key. The keyboard has a special layout offering all the key functionality of the enhanced keyboard but in a narrower than usual, and thus rack mountable, package. The keyboard is firmly mounted in a simple bracket offering the slide mounted capabilities for standard RETMA 19" equipment cabinets.

SPECIFICATIONS

Power Supply

+5VDC +/- 10%

Current Input

18mA Typical

Interface

Bi-directional, serial synchronous
Keyboard and Touchpad communicate over clock and data lines

Touchpad Resolution

500 Points per inch (20 points per mm) Graphic Tablet Mode

Touchpad Interface

PS/2 or Serial RS232 Dependent on Model
Compatible with Microsoft or IBM PS/2 Mouse Driver. Drivers for DOS, Windows 3.1 and Windows 95 included. Windows NT 4.0 drivers available. Updated drivers available at <http://www.synaptics.com>

Data Format

IBM Synchronous

Data Outputs

Open Drain

Data Buffer

Scan codes buffered

Cable Connector

Dual PS/2 connectors

Typematic Function

All keys have auto-repeat
Delay and frequency set from system

Turn-on Reset

Keyboard generates reset signal automatically on power up.



SPECIFICATIONS CONT.

Self Test

Self diagnostic test on power up

MECHANICAL SPECIFICATIONS

Dimensions (H x W x D)

1.7 x 19 x 17in (43.18 x 483 x 432mm)

Temperature

Operating: 0 to +50°C

Storage: -20 to +60°C

Agency Approvals

UL 1950, FCC Part 15, Subpart B

CE

DRAWING

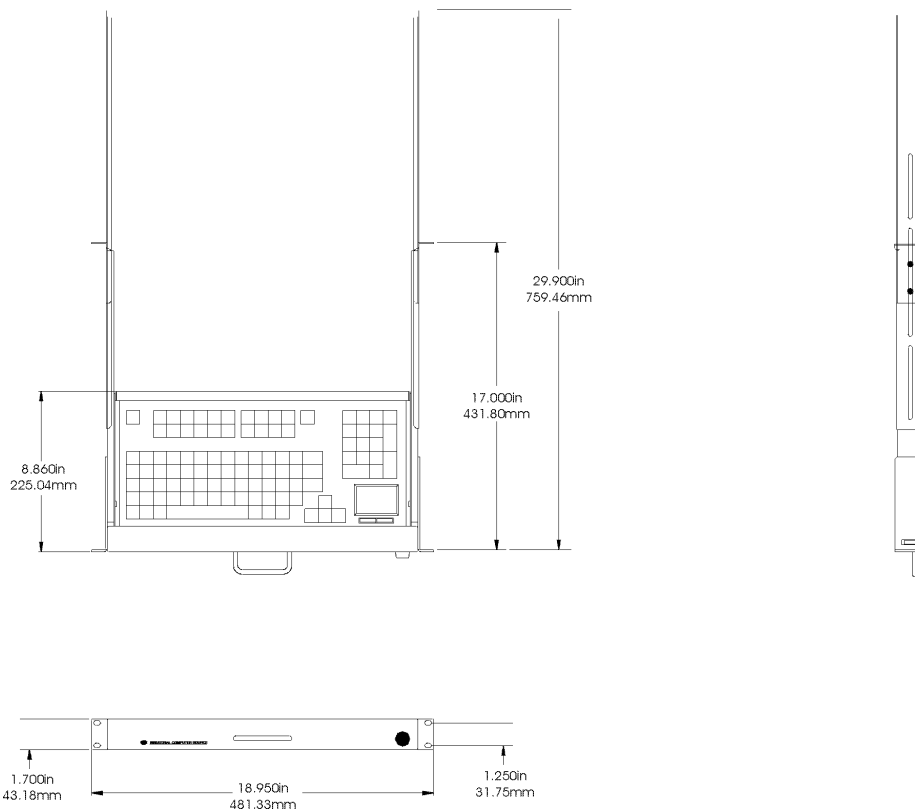

ORDERING GUIDE

Model 6531-KB3TP

Rackmount Keyboard with Touchpad and PS/2 connection, driver disk



6260 Sequence Drive
San Diego, CA 92121
800 523-2320
fax 858 677-0895
www.icsadvent.com